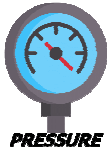

Gas pressure transmitter

Type A transmitters are based on bridge resistance variation principle and the primary element is directly deposited on reaction mechanics by a silk screen-thick film process .

In this way the primary element can be very stable and offer the maximum protection because of monolithic ceramic block.

The innovative pressure sensor combines electronic precision with mechanical resistance for your complete safety in any conditions.

Low cost allows to use this sensor in many situation, above all in automation systems or as a supervisor for mechanical monitoring and process control.

For compatibility with most systems has ¼ gas male output fitting and is suitable for alimentary control because of the choice of material in contact with the fluid in accord with UL sanitation.

4-20mA analog output allows to get quite long distance link between sensor and remote control.

Temperature output allows to record temperature variation of device under control.

APPLICATIONS

- ANALOG RELATIVE PRESSURE & TEMPERATURE SENSOR
- Electronic pressure sensor
- Electronic temperature sensor (optional)
- High accuracy
- IP 65 protection with cable gland
- Wide compensated temperature range
- Compatibility with corrosive fluids
- Primary element deposited on ceramic monolithic block

HIGHLIGHTS*Technical Data*

Pressure FSO range (Bar)...0 – 1.6; 0- 5; 0- 10; 0-20*

Overpressure.....2X rated

Response time (10% to 90%).....5ms

Operating fluid temperature range... - 20° + 85°C

Mechanical protection of active components...IP65

Compatibility with corrosive fluids

*Versions with customized features can be provided

Performance Data

Pressure accuracy (T=Trated± 25°C): +/- 1,5% FSS

TC zero point: <0,025 %FSS/°C

Temperature accuracy: +/- 15°C

Linearity error: +/- 01% FSS

Compensated temperature range: -20° + 85°C

Resolution: infinite

Electrical insulation: 50 Hz 1min 15kV

Electrical Data

Output: 4-20mA , 1-5 Vcc

Excitation: 10-35 VCC

Load: R<750ohm

Plug: DIN 43650 MPM 4 poles connector

Cable LX=1mt optional

Physical descriptions

Material external: stainless steel AISI316

Material in contact with fluid: ceramic, stainless steel and EPDM (or Viton available on request for use with oil)

Pressure fittings: 1/4" gas male/female

Dimensions: ø30x 40mm

Weight: 150 g

All specs are subject to change without notice

Gas pressure transmitter

Rev./Mod A	Data 11.05.2011	Rev./Mod B	Data 02.05.2017	Rev./Mod C	Data 21.06.2017	Rev./Mod D	Data 06.11.2023	Rev./Mod	Data	Rev./Mod	Data
Descrizione: MODIFICHE GENERALI		Descrizione: ADD FEMALE FITTING		Descrizione: MODIFIED MALE TYPE		Descrizione: ADD VITON TYPE		Descrizione:		Descrizione:	

A (2:1)

*O-RING 18.72X2.62 EPDM70PC
*VITON TYPE UPON REQUEST

MALE FITTING

Prep. Ds.	C. FORLANI	ELECTRONSYSTEM MD S.r.l.	
App.	P. GUZZETTI	Resp. Dep. Uff. Resp.	Technical Dept.
First Issue:	10.01.2004	Title Apprechiato	SGM/A analog relative pressure sensor
NOTE :		Dec. No.	43911769
		Scale	1:1
		Rev. No.	1

We reserve all rights in this document and in the information contained therein. Reproduction, use or disclosure to third parties without express authority is strictly forbidden. We reserve also the rights to modify the drawing without notice. Ci riserviamo tutti i diritti connessi con il presente documento e con i dati in esso contenuti. La riproduzione, l'uso o la divulgazione a terzi in assenza di previa autorizzazione di Electronsystem MD S.r.l. è espressamente vietata.

All specs are subject to change without notice

Gas pressure transmitter

Rev./Mod A	Data 11.05.2011	Rev./Mod B	Data 02.05.2017	Rev./Mod C	Data 21.06.2017	Rev./Mod D	Data 06.11.2023	Rev./Mod	Data	Rev./Mod	Data
Descrizione: MODIFICHE GENERALI		Descrizione: ADD FEMALE FITTING		Descrizione: MODIFIED MALE TYPE		Descrizione: ADD VITON TYPE		Descrizione:		Descrizione:	

B (2 : 1)

*O-RING 18.72X2.62 EPDM70PC
*VITON TYPE UPON REQUEST

NOTE :

Prep. Dis.	C. FORLANI	App. P. GUIZZETTI	Resp. Dep. Technical Dept.	
First Issue:	10.01.2004			

ELECTRONSYSTEM MD S.r.l.

SGM/A analog relative pressure sensor

Doc. No. **43911769**

Scale 1:1

FEMALE FITTING

All specs are subject to change without notice

Rev./Mod A	Data	Rev./Mod B	Data	Rev./Mod C	Data	Rev./Mod D	Data	Rev./Mod	Data																																																																																																																																																																																																																																																																																																																																																																																								
Descrizione: MODIFICHE GENERALI	11.05.2011	Descrizione: ADD FEMALE FITTING	02.05.2017	Descrizione: MODIFIED MALE TYPE	21.06.2017	Descrizione: ADD VITON TYPE	06.11.2023	Descrizione:																																																																																																																																																																																																																																																																																																																																																																																									
<p><i>We reserve all rights in this document and in the information contained therein. Reproduction, use or disclosure to third parties without express authority is strictly forbidden. We reserve also the rights to modify the drawing without notice. Ci riserviamo tutti i diritti connessi con il presente documento e con l'oggetto o lo materia in rappresentati con divieto di riproduzione/utilizzo o renderlo accessibile o terzi in assenza di previa autorizzazione. Ci riserviamo anche i diritti di modificare il disegno senza preavviso.</i></p>																																																																																																																																																																																																																																																																																																																																																																																																	
<p>Chemical Material Compatibility</p> <table border="1"> <thead> <tr> <th>CHEMICAL</th> <th>COMPATIBILITY</th> <th>CHEMICAL</th> <th>COMPATIBILITY</th> <th>CHEMICAL</th> <th>COMPATIBILITY</th> <th>CHEMICAL</th> <th>COMPATIBILITY</th> </tr> </thead> <tbody> <tr><td>Acetic Acid</td><td>A - Excellent</td><td>Carbon Dioxide (wet)</td><td>A - Excellent</td><td>Magnesium Hydroxide</td><td>A - Excellent</td><td>Propylene Glycol</td><td>A - Excellent</td></tr> <tr><td>Acetic Acid 20%</td><td>A - Excellent</td><td>Carbon Tetrachloride</td><td>A - Excellent</td><td>Magnesium Nitrate</td><td>A - Excellent</td><td>Pyridine</td><td>A - Excellent</td></tr> <tr><td>Acetic Acid 80%</td><td>A - Excellent</td><td>Carbon Tetrachloride (dry)</td><td>A - Excellent</td><td>Magnesium Sulfate</td><td>A - Excellent</td><td>Seap Solutions</td><td>A - Excellent</td></tr> <tr><td>Acetic Acid, Glacial</td><td>A - Excellent</td><td>Carbon Tetrachloride (wet)</td><td>A - Excellent</td><td>Mercuric Chloride (dilute)</td><td>A - Excellent</td><td>Sodium Acetate</td><td>A - Excellent</td></tr> <tr><td>Acetic Anhydride</td><td>A - Excellent</td><td>Chlorine Water</td><td>A - Excellent</td><td>Mercurous Nitrate</td><td>A - Excellent</td><td>Sodium Bicarbonate</td><td>A - Excellent</td></tr> <tr><td>Acetone</td><td>A - Excellent</td><td>Chlorobenzene (Monom)</td><td>A - Excellent</td><td>Mercury</td><td>A - Excellent</td><td>Sodium Bisulfate</td><td>A - Excellent</td></tr> <tr><td>Alcohol: Amyl</td><td>A - Excellent</td><td>Chlorobromomethane</td><td>A - Excellent</td><td>Methanol (Methyl Alcohol)</td><td>A - Excellent</td><td>Sodium Sulfite</td><td>A - Excellent</td></tr> <tr><td>Alcohol: Benzyl</td><td>A - Excellent</td><td>Chloroform</td><td>A - Excellent</td><td>Methyl Alcohol 10%</td><td>A - Excellent</td><td>Sodium Borate (Borax)</td><td>A - Excellent</td></tr> <tr><td>Alcohol: Butyl</td><td>A - Excellent</td><td>Chloroformic Acid</td><td>A - Excellent</td><td>Methyl Ethyl Ketone</td><td>A - Excellent</td><td>Sodium Carbamate</td><td>A - Excellent</td></tr> <tr><td>Alcohol: Ethyl</td><td>A - Excellent</td><td>Chromic Acid 10%</td><td>A - Excellent</td><td>Milk</td><td>A - Excellent</td><td>Sodium Chloride</td><td>A - Excellent</td></tr> <tr><td>Alcohol: Isopropyl</td><td>A - Excellent</td><td>Chromic Acid 30%</td><td>A - Excellent</td><td>Motor oil</td><td>A - Excellent</td><td>Sodium Chlorate</td><td>A - Excellent</td></tr> <tr><td>Alcohol: Methyl</td><td>A - Excellent</td><td>Chromic Acid 5%</td><td>A - Excellent</td><td>Naphthalene</td><td>A - Excellent</td><td>Sodium Cyanide</td><td>A - Excellent</td></tr> <tr><td>Aluminum Chloride</td><td>A - Excellent</td><td>Chromic Acid 50%</td><td>A - Excellent</td><td>Nickel Chloride</td><td>A - Excellent</td><td>Sodium Ferrocyanide</td><td>A - Excellent</td></tr> <tr><td>Aluminum Chloride 20%</td><td>A - Excellent</td><td>Chloroacetic Acid</td><td>A - Excellent</td><td>Nickel Nitrate</td><td>A - Excellent</td><td>Sodium Fluoride</td><td>A - Excellent</td></tr> <tr><td>Aluminum Sulfate</td><td>A - Excellent</td><td>Citric Acid</td><td>A - Excellent</td><td>Nickel Sulfate</td><td>A - Excellent</td><td>Sodium Hydroxide (20%)</td><td>A - Excellent</td></tr> <tr><td>Ammonia 10%</td><td>A - Excellent</td><td>Copper Cyanide</td><td>A - Excellent</td><td>Nitric Acid (20%)</td><td>A - Excellent</td><td>Sodium Hydroxide (50%)</td><td>A - Excellent</td></tr> <tr><td>Ammonia, Liquid</td><td>A - Excellent</td><td>Copper Nitrate</td><td>A - Excellent</td><td>Nitric Acid (50%)</td><td>A - Excellent</td><td>Sodium Hydroxide (80%)</td><td>A - Excellent</td></tr> <tr><td>Ammonium Carbonate</td><td>A - Excellent</td><td>Copper Sulfate 5%</td><td>A - Excellent</td><td>Nitric Acid (Concentrated)</td><td>A - Excellent</td><td>Sodium Hypochlorite (100%)</td><td>A - Excellent</td></tr> <tr><td>Ammonium Chloride</td><td>A - Excellent</td><td>Detergents</td><td>A - Excellent</td><td>Nitric Acid (5-10%)</td><td>A - Excellent</td><td>Sodium Nitrate</td><td>A - Excellent</td></tr> <tr><td>Ammonium Hydroxide</td><td>A - Excellent</td><td>Dichloroethane</td><td>A - Excellent</td><td>Oils: Castor</td><td>A - Excellent</td><td>Sodium Silicate</td><td>A - Excellent</td></tr> <tr><td>Ammonium Nitrate</td><td>A - Excellent</td><td>Ethanolamine</td><td>A - Excellent</td><td>Oils: Cottonseed</td><td>A - Excellent</td><td>Sodium Sulfate</td><td>A - Excellent</td></tr> <tr><td>Ammonium Persulfate</td><td>A - Excellent</td><td>Ethyl Acetate</td><td>A - Excellent</td><td>Oils: Linseed</td><td>A - Excellent</td><td>Sulfuric Acid</td><td>A - Excellent</td></tr> <tr><td>Ammonium Sulfate</td><td>A - Excellent</td><td>Ethyl Chloride</td><td>A - Excellent</td><td>Oils: Mineral</td><td>A - Excellent</td><td>Sulfuric Acid (10-75%)</td><td>A - Excellent</td></tr> <tr><td>Amyl Acetate</td><td>A - Excellent</td><td>Ethylene Dichloride</td><td>A - Excellent</td><td>Oils: Olive</td><td>A - Excellent</td><td>Sulfuric Acid (75-100%)</td><td>A - Excellent</td></tr> <tr><td>Amyl Alcohol</td><td>A - Excellent</td><td>Ethylene Glycol</td><td>A - Excellent</td><td>Oxalic Acid</td><td>A - Excellent</td><td>Sulfuric Acid (hot concentrated)</td><td>A - Excellent</td></tr> <tr><td>Aniline</td><td>A - Excellent</td><td>Fatty Acids</td><td>A - Excellent</td><td>Paraffin</td><td>A - Excellent</td><td>Tannic Acid</td><td>A - Excellent</td></tr> <tr><td>Antimony Trichloride</td><td>B - Good</td><td>Ferrous Sulfate</td><td>A - Excellent</td><td>Perchloroethylene</td><td>A - Excellent</td><td>Tartaric Acid</td><td>A - Excellent</td></tr> <tr><td>Barium Carbonate</td><td>A - Excellent</td><td>Ferrous Sulfate</td><td>A - Excellent</td><td>Phenol (10%)</td><td>A - Excellent</td><td>Tetrahydrofuran</td><td>A - Excellent</td></tr> <tr><td>Barium Chloride</td><td>A - Excellent</td><td>Ferrous Sulfate</td><td>A - Excellent</td><td>Phenol (Carbolic Acid)</td><td>A - Excellent</td><td>Toluene (Toluol)</td><td>A - Excellent</td></tr> <tr><td>Barium Hydroxide</td><td>A - Excellent</td><td>Ferrous Sulfate</td><td>A - Excellent</td><td>Phosphoric Acid (5-40%)</td><td>A - Excellent</td><td>Trichloroacetic Acid</td><td>A - Excellent</td></tr> <tr><td>Barium Sulfate</td><td>A - Excellent</td><td>Ferrous Sulfate</td><td>A - Excellent</td><td>Phosphoric Acid (5-40%)</td><td>A - Excellent</td><td>Trichloroethylene</td><td>A - Excellent</td></tr> <tr><td>Benzaldehyde</td><td>A - Excellent</td><td>Freon 11</td><td>A - Excellent</td><td>Photographic Developer</td><td>A - Excellent</td><td>Triethylamine</td><td>A - Excellent</td></tr> <tr><td>Benzene</td><td>A - Excellent</td><td>Fruit Juice</td><td>A - Excellent</td><td>Plating Solutions, Lead Fluoborate Plating</td><td>A - Excellent</td><td>Turpentine</td><td>A - Excellent</td></tr> <tr><td>Benzene Sulfonic Acid</td><td>A - Excellent</td><td>Gasoline (light aromatic)</td><td>A - Excellent</td><td>Plating Solutions, Rhodium Plating 120°F</td><td>A - Excellent</td><td>Urea</td><td>B - Good</td></tr> <tr><td>Benzol</td><td>A - Excellent</td><td>Gasoline, leaded, ref.</td><td>A - Excellent</td><td>Potassium Bicarbonate</td><td>A - Excellent</td><td>Vegetable Juice</td><td>A - Excellent</td></tr> <tr><td>Boric Acid</td><td>A - Excellent</td><td>Glycerin</td><td>A - Excellent</td><td>Potassium Chlorate</td><td>B - Good</td><td>Vinegar</td><td>A - Excellent</td></tr> <tr><td>Bromine</td><td>A - Excellent</td><td>Hydrogen Peroxide 100%</td><td>A - Excellent</td><td>Potassium Chromate</td><td>B - Good</td><td>Vinyl Acetate</td><td>B - Good</td></tr> <tr><td>Calcium Carbonate</td><td>A - Excellent</td><td>Hydrogen Sulfide (aque)</td><td>A - Excellent</td><td>Potassium Dichromate</td><td>B - Good</td><td>Vinyl Chloride</td><td>A - Excellent</td></tr> <tr><td>Calcium Chloride</td><td>A - Excellent</td><td>Ink</td><td>A - Excellent</td><td>Potassium Ferricyanide</td><td>B - Good</td><td>Water, Acid, Mine</td><td>A - Excellent</td></tr> <tr><td>Calcium Chloride</td><td>A - Excellent</td><td>Kerosene</td><td>A - Excellent</td><td>Potassium Ferricyanide</td><td>B - Good</td><td>Water, Deionized</td><td>B - Good</td></tr> <tr><td>Calcium Hydroxide</td><td>A - Excellent</td><td>Ketones</td><td>A - Excellent</td><td>Potassium Iodide</td><td>B - Good</td><td>Water, Fresh</td><td>A - Excellent</td></tr> <tr><td>Calcium Hypochlorite</td><td>A - Excellent</td><td>Lead Acetate</td><td>A - Excellent</td><td>Potassium Nitrate</td><td>A - Excellent</td><td>Water, Salt</td><td>B - Good</td></tr> <tr><td>Calcium Nitrate</td><td>A - Excellent</td><td>Lead Acetate</td><td>A - Excellent</td><td>Potassium Oxalate</td><td>A - Excellent</td><td>Weed Killers</td><td>B - Good</td></tr> <tr><td>Calcium Sulfate</td><td>A - Excellent</td><td>Liq: Ca(OH)2 Calcium Hydroxide</td><td>A - Excellent</td><td>Potassium Permanganate</td><td>A - Excellent</td><td>Whiskey & Wines</td><td>A - Excellent</td></tr> <tr><td>Carbolic Acid (Phenol)</td><td>A - Excellent</td><td>Liq: NaOH Sodium Hydroxide</td><td>A - Excellent</td><td>Potassium Sulfate</td><td>A - Excellent</td><td>Xylene</td><td>A - Excellent</td></tr> <tr><td></td><td></td><td>Magnesium Chloride</td><td>A2 - Excellent</td><td></td><td></td><td></td><td></td></tr> </tbody> </table>										CHEMICAL	COMPATIBILITY	CHEMICAL	COMPATIBILITY	CHEMICAL	COMPATIBILITY	CHEMICAL	COMPATIBILITY	Acetic Acid	A - Excellent	Carbon Dioxide (wet)	A - Excellent	Magnesium Hydroxide	A - Excellent	Propylene Glycol	A - Excellent	Acetic Acid 20%	A - Excellent	Carbon Tetrachloride	A - Excellent	Magnesium Nitrate	A - Excellent	Pyridine	A - Excellent	Acetic Acid 80%	A - Excellent	Carbon Tetrachloride (dry)	A - Excellent	Magnesium Sulfate	A - Excellent	Seap Solutions	A - Excellent	Acetic Acid, Glacial	A - Excellent	Carbon Tetrachloride (wet)	A - Excellent	Mercuric Chloride (dilute)	A - Excellent	Sodium Acetate	A - Excellent	Acetic Anhydride	A - Excellent	Chlorine Water	A - Excellent	Mercurous Nitrate	A - Excellent	Sodium Bicarbonate	A - Excellent	Acetone	A - Excellent	Chlorobenzene (Monom)	A - Excellent	Mercury	A - Excellent	Sodium Bisulfate	A - Excellent	Alcohol: Amyl	A - Excellent	Chlorobromomethane	A - Excellent	Methanol (Methyl Alcohol)	A - Excellent	Sodium Sulfite	A - Excellent	Alcohol: Benzyl	A - Excellent	Chloroform	A - Excellent	Methyl Alcohol 10%	A - Excellent	Sodium Borate (Borax)	A - Excellent	Alcohol: Butyl	A - Excellent	Chloroformic Acid	A - Excellent	Methyl Ethyl Ketone	A - Excellent	Sodium Carbamate	A - Excellent	Alcohol: Ethyl	A - Excellent	Chromic Acid 10%	A - Excellent	Milk	A - Excellent	Sodium Chloride	A - Excellent	Alcohol: Isopropyl	A - Excellent	Chromic Acid 30%	A - Excellent	Motor oil	A - Excellent	Sodium Chlorate	A - Excellent	Alcohol: Methyl	A - Excellent	Chromic Acid 5%	A - Excellent	Naphthalene	A - Excellent	Sodium Cyanide	A - Excellent	Aluminum Chloride	A - Excellent	Chromic Acid 50%	A - Excellent	Nickel Chloride	A - Excellent	Sodium Ferrocyanide	A - Excellent	Aluminum Chloride 20%	A - Excellent	Chloroacetic Acid	A - Excellent	Nickel Nitrate	A - Excellent	Sodium Fluoride	A - Excellent	Aluminum Sulfate	A - Excellent	Citric Acid	A - Excellent	Nickel Sulfate	A - Excellent	Sodium Hydroxide (20%)	A - Excellent	Ammonia 10%	A - Excellent	Copper Cyanide	A - Excellent	Nitric Acid (20%)	A - Excellent	Sodium Hydroxide (50%)	A - Excellent	Ammonia, Liquid	A - Excellent	Copper Nitrate	A - Excellent	Nitric Acid (50%)	A - Excellent	Sodium Hydroxide (80%)	A - Excellent	Ammonium Carbonate	A - Excellent	Copper Sulfate 5%	A - Excellent	Nitric Acid (Concentrated)	A - Excellent	Sodium Hypochlorite (100%)	A - Excellent	Ammonium Chloride	A - Excellent	Detergents	A - Excellent	Nitric Acid (5-10%)	A - Excellent	Sodium Nitrate	A - Excellent	Ammonium Hydroxide	A - Excellent	Dichloroethane	A - Excellent	Oils: Castor	A - Excellent	Sodium Silicate	A - Excellent	Ammonium Nitrate	A - Excellent	Ethanolamine	A - Excellent	Oils: Cottonseed	A - Excellent	Sodium Sulfate	A - Excellent	Ammonium Persulfate	A - Excellent	Ethyl Acetate	A - Excellent	Oils: Linseed	A - Excellent	Sulfuric Acid	A - Excellent	Ammonium Sulfate	A - Excellent	Ethyl Chloride	A - Excellent	Oils: Mineral	A - Excellent	Sulfuric Acid (10-75%)	A - Excellent	Amyl Acetate	A - Excellent	Ethylene Dichloride	A - Excellent	Oils: Olive	A - Excellent	Sulfuric Acid (75-100%)	A - Excellent	Amyl Alcohol	A - Excellent	Ethylene Glycol	A - Excellent	Oxalic Acid	A - Excellent	Sulfuric Acid (hot concentrated)	A - Excellent	Aniline	A - Excellent	Fatty Acids	A - Excellent	Paraffin	A - Excellent	Tannic Acid	A - Excellent	Antimony Trichloride	B - Good	Ferrous Sulfate	A - Excellent	Perchloroethylene	A - Excellent	Tartaric Acid	A - Excellent	Barium Carbonate	A - Excellent	Ferrous Sulfate	A - Excellent	Phenol (10%)	A - Excellent	Tetrahydrofuran	A - Excellent	Barium Chloride	A - Excellent	Ferrous Sulfate	A - Excellent	Phenol (Carbolic Acid)	A - Excellent	Toluene (Toluol)	A - Excellent	Barium Hydroxide	A - Excellent	Ferrous Sulfate	A - Excellent	Phosphoric Acid (5-40%)	A - Excellent	Trichloroacetic Acid	A - Excellent	Barium Sulfate	A - Excellent	Ferrous Sulfate	A - Excellent	Phosphoric Acid (5-40%)	A - Excellent	Trichloroethylene	A - Excellent	Benzaldehyde	A - Excellent	Freon 11	A - Excellent	Photographic Developer	A - Excellent	Triethylamine	A - Excellent	Benzene	A - Excellent	Fruit Juice	A - Excellent	Plating Solutions, Lead Fluoborate Plating	A - Excellent	Turpentine	A - Excellent	Benzene Sulfonic Acid	A - Excellent	Gasoline (light aromatic)	A - Excellent	Plating Solutions, Rhodium Plating 120°F	A - Excellent	Urea	B - Good	Benzol	A - Excellent	Gasoline, leaded, ref.	A - Excellent	Potassium Bicarbonate	A - Excellent	Vegetable Juice	A - Excellent	Boric Acid	A - Excellent	Glycerin	A - Excellent	Potassium Chlorate	B - Good	Vinegar	A - Excellent	Bromine	A - Excellent	Hydrogen Peroxide 100%	A - Excellent	Potassium Chromate	B - Good	Vinyl Acetate	B - Good	Calcium Carbonate	A - Excellent	Hydrogen Sulfide (aque)	A - Excellent	Potassium Dichromate	B - Good	Vinyl Chloride	A - Excellent	Calcium Chloride	A - Excellent	Ink	A - Excellent	Potassium Ferricyanide	B - Good	Water, Acid, Mine	A - Excellent	Calcium Chloride	A - Excellent	Kerosene	A - Excellent	Potassium Ferricyanide	B - Good	Water, Deionized	B - Good	Calcium Hydroxide	A - Excellent	Ketones	A - Excellent	Potassium Iodide	B - Good	Water, Fresh	A - Excellent	Calcium Hypochlorite	A - Excellent	Lead Acetate	A - Excellent	Potassium Nitrate	A - Excellent	Water, Salt	B - Good	Calcium Nitrate	A - Excellent	Lead Acetate	A - Excellent	Potassium Oxalate	A - Excellent	Weed Killers	B - Good	Calcium Sulfate	A - Excellent	Liq: Ca(OH)2 Calcium Hydroxide	A - Excellent	Potassium Permanganate	A - Excellent	Whiskey & Wines	A - Excellent	Carbolic Acid (Phenol)	A - Excellent	Liq: NaOH Sodium Hydroxide	A - Excellent	Potassium Sulfate	A - Excellent	Xylene	A - Excellent			Magnesium Chloride	A2 - Excellent				
CHEMICAL	COMPATIBILITY	CHEMICAL	COMPATIBILITY	CHEMICAL	COMPATIBILITY	CHEMICAL	COMPATIBILITY																																																																																																																																																																																																																																																																																																																																																																																										
Acetic Acid	A - Excellent	Carbon Dioxide (wet)	A - Excellent	Magnesium Hydroxide	A - Excellent	Propylene Glycol	A - Excellent																																																																																																																																																																																																																																																																																																																																																																																										
Acetic Acid 20%	A - Excellent	Carbon Tetrachloride	A - Excellent	Magnesium Nitrate	A - Excellent	Pyridine	A - Excellent																																																																																																																																																																																																																																																																																																																																																																																										
Acetic Acid 80%	A - Excellent	Carbon Tetrachloride (dry)	A - Excellent	Magnesium Sulfate	A - Excellent	Seap Solutions	A - Excellent																																																																																																																																																																																																																																																																																																																																																																																										
Acetic Acid, Glacial	A - Excellent	Carbon Tetrachloride (wet)	A - Excellent	Mercuric Chloride (dilute)	A - Excellent	Sodium Acetate	A - Excellent																																																																																																																																																																																																																																																																																																																																																																																										
Acetic Anhydride	A - Excellent	Chlorine Water	A - Excellent	Mercurous Nitrate	A - Excellent	Sodium Bicarbonate	A - Excellent																																																																																																																																																																																																																																																																																																																																																																																										
Acetone	A - Excellent	Chlorobenzene (Monom)	A - Excellent	Mercury	A - Excellent	Sodium Bisulfate	A - Excellent																																																																																																																																																																																																																																																																																																																																																																																										
Alcohol: Amyl	A - Excellent	Chlorobromomethane	A - Excellent	Methanol (Methyl Alcohol)	A - Excellent	Sodium Sulfite	A - Excellent																																																																																																																																																																																																																																																																																																																																																																																										
Alcohol: Benzyl	A - Excellent	Chloroform	A - Excellent	Methyl Alcohol 10%	A - Excellent	Sodium Borate (Borax)	A - Excellent																																																																																																																																																																																																																																																																																																																																																																																										
Alcohol: Butyl	A - Excellent	Chloroformic Acid	A - Excellent	Methyl Ethyl Ketone	A - Excellent	Sodium Carbamate	A - Excellent																																																																																																																																																																																																																																																																																																																																																																																										
Alcohol: Ethyl	A - Excellent	Chromic Acid 10%	A - Excellent	Milk	A - Excellent	Sodium Chloride	A - Excellent																																																																																																																																																																																																																																																																																																																																																																																										
Alcohol: Isopropyl	A - Excellent	Chromic Acid 30%	A - Excellent	Motor oil	A - Excellent	Sodium Chlorate	A - Excellent																																																																																																																																																																																																																																																																																																																																																																																										
Alcohol: Methyl	A - Excellent	Chromic Acid 5%	A - Excellent	Naphthalene	A - Excellent	Sodium Cyanide	A - Excellent																																																																																																																																																																																																																																																																																																																																																																																										
Aluminum Chloride	A - Excellent	Chromic Acid 50%	A - Excellent	Nickel Chloride	A - Excellent	Sodium Ferrocyanide	A - Excellent																																																																																																																																																																																																																																																																																																																																																																																										
Aluminum Chloride 20%	A - Excellent	Chloroacetic Acid	A - Excellent	Nickel Nitrate	A - Excellent	Sodium Fluoride	A - Excellent																																																																																																																																																																																																																																																																																																																																																																																										
Aluminum Sulfate	A - Excellent	Citric Acid	A - Excellent	Nickel Sulfate	A - Excellent	Sodium Hydroxide (20%)	A - Excellent																																																																																																																																																																																																																																																																																																																																																																																										
Ammonia 10%	A - Excellent	Copper Cyanide	A - Excellent	Nitric Acid (20%)	A - Excellent	Sodium Hydroxide (50%)	A - Excellent																																																																																																																																																																																																																																																																																																																																																																																										
Ammonia, Liquid	A - Excellent	Copper Nitrate	A - Excellent	Nitric Acid (50%)	A - Excellent	Sodium Hydroxide (80%)	A - Excellent																																																																																																																																																																																																																																																																																																																																																																																										
Ammonium Carbonate	A - Excellent	Copper Sulfate 5%	A - Excellent	Nitric Acid (Concentrated)	A - Excellent	Sodium Hypochlorite (100%)	A - Excellent																																																																																																																																																																																																																																																																																																																																																																																										
Ammonium Chloride	A - Excellent	Detergents	A - Excellent	Nitric Acid (5-10%)	A - Excellent	Sodium Nitrate	A - Excellent																																																																																																																																																																																																																																																																																																																																																																																										
Ammonium Hydroxide	A - Excellent	Dichloroethane	A - Excellent	Oils: Castor	A - Excellent	Sodium Silicate	A - Excellent																																																																																																																																																																																																																																																																																																																																																																																										
Ammonium Nitrate	A - Excellent	Ethanolamine	A - Excellent	Oils: Cottonseed	A - Excellent	Sodium Sulfate	A - Excellent																																																																																																																																																																																																																																																																																																																																																																																										
Ammonium Persulfate	A - Excellent	Ethyl Acetate	A - Excellent	Oils: Linseed	A - Excellent	Sulfuric Acid	A - Excellent																																																																																																																																																																																																																																																																																																																																																																																										
Ammonium Sulfate	A - Excellent	Ethyl Chloride	A - Excellent	Oils: Mineral	A - Excellent	Sulfuric Acid (10-75%)	A - Excellent																																																																																																																																																																																																																																																																																																																																																																																										
Amyl Acetate	A - Excellent	Ethylene Dichloride	A - Excellent	Oils: Olive	A - Excellent	Sulfuric Acid (75-100%)	A - Excellent																																																																																																																																																																																																																																																																																																																																																																																										
Amyl Alcohol	A - Excellent	Ethylene Glycol	A - Excellent	Oxalic Acid	A - Excellent	Sulfuric Acid (hot concentrated)	A - Excellent																																																																																																																																																																																																																																																																																																																																																																																										
Aniline	A - Excellent	Fatty Acids	A - Excellent	Paraffin	A - Excellent	Tannic Acid	A - Excellent																																																																																																																																																																																																																																																																																																																																																																																										
Antimony Trichloride	B - Good	Ferrous Sulfate	A - Excellent	Perchloroethylene	A - Excellent	Tartaric Acid	A - Excellent																																																																																																																																																																																																																																																																																																																																																																																										
Barium Carbonate	A - Excellent	Ferrous Sulfate	A - Excellent	Phenol (10%)	A - Excellent	Tetrahydrofuran	A - Excellent																																																																																																																																																																																																																																																																																																																																																																																										
Barium Chloride	A - Excellent	Ferrous Sulfate	A - Excellent	Phenol (Carbolic Acid)	A - Excellent	Toluene (Toluol)	A - Excellent																																																																																																																																																																																																																																																																																																																																																																																										
Barium Hydroxide	A - Excellent	Ferrous Sulfate	A - Excellent	Phosphoric Acid (5-40%)	A - Excellent	Trichloroacetic Acid	A - Excellent																																																																																																																																																																																																																																																																																																																																																																																										
Barium Sulfate	A - Excellent	Ferrous Sulfate	A - Excellent	Phosphoric Acid (5-40%)	A - Excellent	Trichloroethylene	A - Excellent																																																																																																																																																																																																																																																																																																																																																																																										
Benzaldehyde	A - Excellent	Freon 11	A - Excellent	Photographic Developer	A - Excellent	Triethylamine	A - Excellent																																																																																																																																																																																																																																																																																																																																																																																										
Benzene	A - Excellent	Fruit Juice	A - Excellent	Plating Solutions, Lead Fluoborate Plating	A - Excellent	Turpentine	A - Excellent																																																																																																																																																																																																																																																																																																																																																																																										
Benzene Sulfonic Acid	A - Excellent	Gasoline (light aromatic)	A - Excellent	Plating Solutions, Rhodium Plating 120°F	A - Excellent	Urea	B - Good																																																																																																																																																																																																																																																																																																																																																																																										
Benzol	A - Excellent	Gasoline, leaded, ref.	A - Excellent	Potassium Bicarbonate	A - Excellent	Vegetable Juice	A - Excellent																																																																																																																																																																																																																																																																																																																																																																																										
Boric Acid	A - Excellent	Glycerin	A - Excellent	Potassium Chlorate	B - Good	Vinegar	A - Excellent																																																																																																																																																																																																																																																																																																																																																																																										
Bromine	A - Excellent	Hydrogen Peroxide 100%	A - Excellent	Potassium Chromate	B - Good	Vinyl Acetate	B - Good																																																																																																																																																																																																																																																																																																																																																																																										
Calcium Carbonate	A - Excellent	Hydrogen Sulfide (aque)	A - Excellent	Potassium Dichromate	B - Good	Vinyl Chloride	A - Excellent																																																																																																																																																																																																																																																																																																																																																																																										
Calcium Chloride	A - Excellent	Ink	A - Excellent	Potassium Ferricyanide	B - Good	Water, Acid, Mine	A - Excellent																																																																																																																																																																																																																																																																																																																																																																																										
Calcium Chloride	A - Excellent	Kerosene	A - Excellent	Potassium Ferricyanide	B - Good	Water, Deionized	B - Good																																																																																																																																																																																																																																																																																																																																																																																										
Calcium Hydroxide	A - Excellent	Ketones	A - Excellent	Potassium Iodide	B - Good	Water, Fresh	A - Excellent																																																																																																																																																																																																																																																																																																																																																																																										
Calcium Hypochlorite	A - Excellent	Lead Acetate	A - Excellent	Potassium Nitrate	A - Excellent	Water, Salt	B - Good																																																																																																																																																																																																																																																																																																																																																																																										
Calcium Nitrate	A - Excellent	Lead Acetate	A - Excellent	Potassium Oxalate	A - Excellent	Weed Killers	B - Good																																																																																																																																																																																																																																																																																																																																																																																										
Calcium Sulfate	A - Excellent	Liq: Ca(OH)2 Calcium Hydroxide	A - Excellent	Potassium Permanganate	A - Excellent	Whiskey & Wines	A - Excellent																																																																																																																																																																																																																																																																																																																																																																																										
Carbolic Acid (Phenol)	A - Excellent	Liq: NaOH Sodium Hydroxide	A - Excellent	Potassium Sulfate	A - Excellent	Xylene	A - Excellent																																																																																																																																																																																																																																																																																																																																																																																										
		Magnesium Chloride	A2 - Excellent																																																																																																																																																																																																																																																																																																																																																																																														
<p>Chemical Material Compatibility</p> <table border="1"> <thead> <tr> <th>CHEMICAL</th> <th>COMPATIBILITY</th> <th>CHEMICAL</th> <th>COMPATIBILITY</th> <th>CHEMICAL</th> <th>COMPATIBILITY</th> <th>CHEMICAL</th> <th>COMPATIBILITY</th> </tr> </thead> <tbody> <tr><td>Magnesium Hydroxide</td><td>A - Excellent</td><td>Nitric Acid (Concentrated)</td><td>A - Excellent</td><td>Sulfuric Acid (10-75%)</td><td>A - Excellent</td><td>Sulfuric Acid (10-75%)</td><td>A - Excellent</td></tr> <tr><td>Magnesium Nitrate</td><td>A - Excellent</td><td>Oils: Castor</td><td>A - Excellent</td><td>Sulfuric Acid (75-100%)</td><td>A - Excellent</td><td>Sulfuric Acid (hot concentrated)</td><td>A - Excellent</td></tr> <tr><td>Magnesium Sulfate</td><td>A - Excellent</td><td>Oils: Cottonseed</td><td>A - Excellent</td><td>Phenol (10%)</td><td>A - Excellent</td><td>Tannic Acid</td><td>A - Excellent</td></tr> <tr><td>Mercuric Chloride (dilute)</td><td>A - Excellent</td><td>Oils: Linseed</td><td>A - Excellent</td><td>Phenol (Carbolic Acid)</td><td>A - Excellent</td><td>Tartaric Acid</td><td>A - Excellent</td></tr> <tr><td>Mercurous Nitrate</td><td>A - Excellent</td><td>Oils: Mineral</td><td>A - Excellent</td><td>Phosphoric Acid (5-40%)</td><td>A - Excellent</td><td>Tetrahydrofuran</td><td>A - Excellent</td></tr> <tr><td>Mercury</td><td>A - Excellent</td><td>Oils: Olive</td><td>A - Excellent</td><td>Phosphoric Acid (5-40%)</td><td>A - Excellent</td><td>Toluene (Toluol)</td><td>A - Excellent</td></tr> <tr><td>Methanol (Methyl Alcohol)</td><td>A - Excellent</td><td>Oxalic Acid</td><td>A - Excellent</td><td>Photographic Developer</td><td>A - Excellent</td><td>Trichloroacetic Acid</td><td>A - Excellent</td></tr> <tr><td>Methyl Alcohol 10%</td><td>A - Excellent</td><td>Paraffin</td><td>A - Excellent</td><td>Plating Solutions, Lead Fluoborate Plating</td><td>A - Excellent</td><td>Trichloroethylene</td><td>A - Excellent</td></tr> <tr><td>Methyl Ethyl Ketone</td><td>A - Excellent</td><td>Perchloroethylene</td><td>A - Excellent</td><td>Plating Solutions, Rhodium Plating 120°F</td><td>A - Excellent</td><td>Triethylamine</td><td>A - Excellent</td></tr> <tr><td>Milk</td><td>A - Excellent</td><td>Phenol (10%)</td><td>A - Excellent</td><td>Potassium Bicarbonate</td><td>A - Excellent</td><td>Turpentine</td><td>A - Excellent</td></tr> <tr><td>Motor oil</td><td>A - Excellent</td><td>Phenol (Carbolic Acid)</td><td>A - Excellent</td><td>Potassium Chlorate</td><td>B - Good</td><td>Urea</td><td>B - Good</td></tr> <tr><td>Naphthalene</td><td>A - Excellent</td><td>Phosphoric Acid (5-40%)</td><td>A - Excellent</td><td>Potassium Chromate</td><td>B - Good</td><td>Vegetable Juice</td><td>A - Excellent</td></tr> <tr><td>Nickel Chloride</td><td>A - Excellent</td><td>Phosphoric Acid (5-40%)</td><td>A - Excellent</td><td>Potassium Dichromate</td><td>B - Good</td><td>Vinegar</td><td>A - Excellent</td></tr> <tr><td>Nickel Nitrate</td><td>A - Excellent</td><td>Photographic Developer</td><td>A - Excellent</td><td>Potassium Ferricyanide</td><td>B - Good</td><td>Vinyl Acetate</td><td>B - Good</td></tr> <tr><td>Nickel Sulfate</td><td>A - Excellent</td><td>Plating Solutions, Lead Fluoborate Plating</td><td>A - Excellent</td><td>Potassium Ferricyanide</td><td>B - Good</td><td>Vinyl Chloride</td><td>A - Excellent</td></tr> <tr><td>Nitric Acid (20%)</td><td>A - Excellent</td><td>Plating Solutions, Rhodium Plating 120°F</td><td>A - Excellent</td><td>Potassium Iodide</td><td>B - Good</td><td>Water, Acid, Mine</td><td>A - Excellent</td></tr> <tr><td>Nitric Acid (50%)</td><td>A - Excellent</td><td>Potassium Bicarbonate</td><td>A - Excellent</td><td>Potassium Nitrate</td><td>A - Excellent</td><td>Water, Deionized</td><td>B - Good</td></tr> <tr><td>Nitric Acid (Concentrated)</td><td>A - Excellent</td><td>Potassium Chlorate</td><td>B - Good</td><td>Potassium Oxalate</td><td>A - Excellent</td><td>Water, Fresh</td><td>A - Excellent</td></tr> <tr><td>Nitric Acid (5-10%)</td><td>A - Excellent</td><td>Potassium Chromate</td><td>B - Good</td><td>Potassium Permanganate</td><td>A - Excellent</td><td>Water, Salt</td><td>B - Good</td></tr> <tr><td>Oils: Castor</td><td>A - Excellent</td><td>Potassium Dichromate</td><td>B - Good</td><td>Potassium Sulfate</td><td>A - Excellent</td><td>Weed Killers</td><td>B - Good</td></tr> <tr><td>Oils: Cottonseed</td><td>A - Excellent</td><td>Potassium Ferricyanide</td><td>B - Good</td><td></td><td></td><td>Whiskey & Wines</td><td>A - Excellent</td></tr> <tr><td>Oils: Linseed</td><td>A - Excellent</td><td>Potassium Ferricyanide</td><td>B - Good</td><td></td><td></td><td>Xylene</td><td>A - Excellent</td></tr> <tr><td>Oils: Mineral</td><td>A - Excellent</td><td>Potassium Iodide</td><td>B - Good</td><td></td><td></td><td></td><td></td></tr> <tr><td>Oils: Olive</td><td>A - Excellent</td><td>Potassium Nitrate</td><td>A - Excellent</td><td></td><td></td><td></td><td></td></tr> <tr><td>Oxalic Acid</td><td>A - Excellent</td><td>Potassium Oxalate</td><td>A - Excellent</td><td></td><td></td><td></td><td></td></tr> <tr><td>Oxalic Acid (cold)</td><td>A - Excellent</td><td>Potassium Permanganate</td><td>A - Excellent</td><td></td><td></td><td></td><td></td></tr> <tr><td>Paraffin</td><td>A - Excellent</td><td>Potassium Sulfate</td><td>A - Excellent</td><td></td><td></td><td></td><td></td></tr> <tr><td>Perchloroethylene</td><td>A - Excellent</td><td></td><td></td><td></td><td></td><td></td><td></td></tr> <tr><td>Phenol (10%)</td><td>A - Excellent</td><td></td><td></td><td></td><td></td><td></td><td></td></tr> <tr><td>Phenol (Carbolic Acid)</td><td>A - Excellent</td><td></td><td></td><td></td><td></td><td></td><td></td></tr> <tr><td>Phosphoric Acid (5-40%)</td><td>A - Excellent</td><td></td><td></td><td></td><td></td><td></td><td></td></tr> <tr><td>Phosphoric Acid (5-40%)</td><td>A - Excellent</td><td></td><td></td><td></td><td></td><td></td><td></td></tr> <tr><td>Photographic Developer</td><td>A - Excellent</td><td></td><td></td><td></td><td></td><td></td><td></td></tr> <tr><td>Plating Solutions, Lead Fluoborate Plating</td><td>A - Excellent</td><td></td><td></td><td></td><td></td><td></td><td></td></tr> <tr><td>Plating Solutions, Rhodium Plating 120°F</td><td>A - Excellent</td><td></td><td></td><td></td><td></td><td></td><td></td></tr> <tr><td>Potassium Bicarbonate</td><td>A - Excellent</td><td></td><td></td><td></td><td></td><td></td><td></td></tr> <tr><td>Potassium Chlorate</td><td>B - Good</td><td></td><td></td><td></td><td></td><td></td><td></td></tr> <tr><td>Potassium Chromate</td><td>B - Good</td><td></td><td></td><td></td><td></td><td></td><td></td></tr> <tr><td>Potassium Dichromate</td><td>B - Good</td><td></td><td></td><td></td><td></td><td></td><td></td></tr> <tr><td>Potassium Ferricyanide</td><td>B - Good</td><td></td><td></td><td></td><td></td><td></td><td></td></tr> <tr><td>Potassium Ferricyanide</td><td>B - Good</td><td></td><td></td><td></td><td></td><td></td><td></td></tr> <tr><td>Potassium Iodide</td><td>B - Good</td><td></td><td></td><td></td><td></td><td></td><td></td></tr> <tr><td>Potassium Nitrate</td><td>A - Excellent</td><td></td><td></td><td></td><td></td><td></td><td></td></tr> <tr><td>Potassium Oxalate</td><td>A - Excellent</td><td></td><td></td><td></td><td></td><td></td><td></td></tr> <tr><td>Potassium Permanganate</td><td>A - Excellent</td><td></td><td></td><td></td><td></td><td></td><td></td></tr> <tr><td>Potassium Sulfate</td><td>A - Excellent</td><td></td><td></td><td></td><td></td><td></td><td></td></tr> </tbody> </table>										CHEMICAL	COMPATIBILITY	CHEMICAL	COMPATIBILITY	CHEMICAL	COMPATIBILITY	CHEMICAL	COMPATIBILITY	Magnesium Hydroxide	A - Excellent	Nitric Acid (Concentrated)	A - Excellent	Sulfuric Acid (10-75%)	A - Excellent	Sulfuric Acid (10-75%)	A - Excellent	Magnesium Nitrate	A - Excellent	Oils: Castor	A - Excellent	Sulfuric Acid (75-100%)	A - Excellent	Sulfuric Acid (hot concentrated)	A - Excellent	Magnesium Sulfate	A - Excellent	Oils: Cottonseed	A - Excellent	Phenol (10%)	A - Excellent	Tannic Acid	A - Excellent	Mercuric Chloride (dilute)	A - Excellent	Oils: Linseed	A - Excellent	Phenol (Carbolic Acid)	A - Excellent	Tartaric Acid	A - Excellent	Mercurous Nitrate	A - Excellent	Oils: Mineral	A - Excellent	Phosphoric Acid (5-40%)	A - Excellent	Tetrahydrofuran	A - Excellent	Mercury	A - Excellent	Oils: Olive	A - Excellent	Phosphoric Acid (5-40%)	A - Excellent	Toluene (Toluol)	A - Excellent	Methanol (Methyl Alcohol)	A - Excellent	Oxalic Acid	A - Excellent	Photographic Developer	A - Excellent	Trichloroacetic Acid	A - Excellent	Methyl Alcohol 10%	A - Excellent	Paraffin	A - Excellent	Plating Solutions, Lead Fluoborate Plating	A - Excellent	Trichloroethylene	A - Excellent	Methyl Ethyl Ketone	A - Excellent	Perchloroethylene	A - Excellent	Plating Solutions, Rhodium Plating 120°F	A - Excellent	Triethylamine	A - Excellent	Milk	A - Excellent	Phenol (10%)	A - Excellent	Potassium Bicarbonate	A - Excellent	Turpentine	A - Excellent	Motor oil	A - Excellent	Phenol (Carbolic Acid)	A - Excellent	Potassium Chlorate	B - Good	Urea	B - Good	Naphthalene	A - Excellent	Phosphoric Acid (5-40%)	A - Excellent	Potassium Chromate	B - Good	Vegetable Juice	A - Excellent	Nickel Chloride	A - Excellent	Phosphoric Acid (5-40%)	A - Excellent	Potassium Dichromate	B - Good	Vinegar	A - Excellent	Nickel Nitrate	A - Excellent	Photographic Developer	A - Excellent	Potassium Ferricyanide	B - Good	Vinyl Acetate	B - Good	Nickel Sulfate	A - Excellent	Plating Solutions, Lead Fluoborate Plating	A - Excellent	Potassium Ferricyanide	B - Good	Vinyl Chloride	A - Excellent	Nitric Acid (20%)	A - Excellent	Plating Solutions, Rhodium Plating 120°F	A - Excellent	Potassium Iodide	B - Good	Water, Acid, Mine	A - Excellent	Nitric Acid (50%)	A - Excellent	Potassium Bicarbonate	A - Excellent	Potassium Nitrate	A - Excellent	Water, Deionized	B - Good	Nitric Acid (Concentrated)	A - Excellent	Potassium Chlorate	B - Good	Potassium Oxalate	A - Excellent	Water, Fresh	A - Excellent	Nitric Acid (5-10%)	A - Excellent	Potassium Chromate	B - Good	Potassium Permanganate	A - Excellent	Water, Salt	B - Good	Oils: Castor	A - Excellent	Potassium Dichromate	B - Good	Potassium Sulfate	A - Excellent	Weed Killers	B - Good	Oils: Cottonseed	A - Excellent	Potassium Ferricyanide	B - Good			Whiskey & Wines	A - Excellent	Oils: Linseed	A - Excellent	Potassium Ferricyanide	B - Good			Xylene	A - Excellent	Oils: Mineral	A - Excellent	Potassium Iodide	B - Good					Oils: Olive	A - Excellent	Potassium Nitrate	A - Excellent					Oxalic Acid	A - Excellent	Potassium Oxalate	A - Excellent					Oxalic Acid (cold)	A - Excellent	Potassium Permanganate	A - Excellent					Paraffin	A - Excellent	Potassium Sulfate	A - Excellent					Perchloroethylene	A - Excellent							Phenol (10%)	A - Excellent							Phenol (Carbolic Acid)	A - Excellent							Phosphoric Acid (5-40%)	A - Excellent							Phosphoric Acid (5-40%)	A - Excellent							Photographic Developer	A - Excellent							Plating Solutions, Lead Fluoborate Plating	A - Excellent							Plating Solutions, Rhodium Plating 120°F	A - Excellent							Potassium Bicarbonate	A - Excellent							Potassium Chlorate	B - Good							Potassium Chromate	B - Good							Potassium Dichromate	B - Good							Potassium Ferricyanide	B - Good							Potassium Ferricyanide	B - Good							Potassium Iodide	B - Good							Potassium Nitrate	A - Excellent							Potassium Oxalate	A - Excellent							Potassium Permanganate	A - Excellent							Potassium Sulfate	A - Excellent						
CHEMICAL	COMPATIBILITY	CHEMICAL	COMPATIBILITY	CHEMICAL	COMPATIBILITY	CHEMICAL	COMPATIBILITY																																																																																																																																																																																																																																																																																																																																																																																										
Magnesium Hydroxide	A - Excellent	Nitric Acid (Concentrated)	A - Excellent	Sulfuric Acid (10-75%)	A - Excellent	Sulfuric Acid (10-75%)	A - Excellent																																																																																																																																																																																																																																																																																																																																																																																										
Magnesium Nitrate	A - Excellent	Oils: Castor	A - Excellent	Sulfuric Acid (75-100%)	A - Excellent	Sulfuric Acid (hot concentrated)	A - Excellent																																																																																																																																																																																																																																																																																																																																																																																										
Magnesium Sulfate	A - Excellent	Oils: Cottonseed	A - Excellent	Phenol (10%)	A - Excellent	Tannic Acid	A - Excellent																																																																																																																																																																																																																																																																																																																																																																																										
Mercuric Chloride (dilute)	A - Excellent	Oils: Linseed	A - Excellent	Phenol (Carbolic Acid)	A - Excellent	Tartaric Acid	A - Excellent																																																																																																																																																																																																																																																																																																																																																																																										
Mercurous Nitrate	A - Excellent	Oils: Mineral	A - Excellent	Phosphoric Acid (5-40%)	A - Excellent	Tetrahydrofuran	A - Excellent																																																																																																																																																																																																																																																																																																																																																																																										
Mercury	A - Excellent	Oils: Olive	A - Excellent	Phosphoric Acid (5-40%)	A - Excellent	Toluene (Toluol)	A - Excellent																																																																																																																																																																																																																																																																																																																																																																																										
Methanol (Methyl Alcohol)	A - Excellent	Oxalic Acid	A - Excellent	Photographic Developer	A - Excellent	Trichloroacetic Acid	A - Excellent																																																																																																																																																																																																																																																																																																																																																																																										
Methyl Alcohol 10%	A - Excellent	Paraffin	A - Excellent	Plating Solutions, Lead Fluoborate Plating	A - Excellent	Trichloroethylene	A - Excellent																																																																																																																																																																																																																																																																																																																																																																																										
Methyl Ethyl Ketone	A - Excellent	Perchloroethylene	A - Excellent	Plating Solutions, Rhodium Plating 120°F	A - Excellent	Triethylamine	A - Excellent																																																																																																																																																																																																																																																																																																																																																																																										
Milk	A - Excellent	Phenol (10%)	A - Excellent	Potassium Bicarbonate	A - Excellent	Turpentine	A - Excellent																																																																																																																																																																																																																																																																																																																																																																																										
Motor oil	A - Excellent	Phenol (Carbolic Acid)	A - Excellent	Potassium Chlorate	B - Good	Urea	B - Good																																																																																																																																																																																																																																																																																																																																																																																										
Naphthalene	A - Excellent	Phosphoric Acid (5-40%)	A - Excellent	Potassium Chromate	B - Good	Vegetable Juice	A - Excellent																																																																																																																																																																																																																																																																																																																																																																																										
Nickel Chloride	A - Excellent	Phosphoric Acid (5-40%)	A - Excellent	Potassium Dichromate	B - Good	Vinegar	A - Excellent																																																																																																																																																																																																																																																																																																																																																																																										
Nickel Nitrate	A - Excellent	Photographic Developer	A - Excellent	Potassium Ferricyanide	B - Good	Vinyl Acetate	B - Good																																																																																																																																																																																																																																																																																																																																																																																										
Nickel Sulfate	A - Excellent	Plating Solutions, Lead Fluoborate Plating	A - Excellent	Potassium Ferricyanide	B - Good	Vinyl Chloride	A - Excellent																																																																																																																																																																																																																																																																																																																																																																																										
Nitric Acid (20%)	A - Excellent	Plating Solutions, Rhodium Plating 120°F	A - Excellent	Potassium Iodide	B - Good	Water, Acid, Mine	A - Excellent																																																																																																																																																																																																																																																																																																																																																																																										
Nitric Acid (50%)	A - Excellent	Potassium Bicarbonate	A - Excellent	Potassium Nitrate	A - Excellent	Water, Deionized	B - Good																																																																																																																																																																																																																																																																																																																																																																																										
Nitric Acid (Concentrated)	A - Excellent	Potassium Chlorate	B - Good	Potassium Oxalate	A - Excellent	Water, Fresh	A - Excellent																																																																																																																																																																																																																																																																																																																																																																																										
Nitric Acid (5-10%)	A - Excellent	Potassium Chromate	B - Good	Potassium Permanganate	A - Excellent	Water, Salt	B - Good																																																																																																																																																																																																																																																																																																																																																																																										
Oils: Castor	A - Excellent	Potassium Dichromate	B - Good	Potassium Sulfate	A - Excellent	Weed Killers	B - Good																																																																																																																																																																																																																																																																																																																																																																																										
Oils: Cottonseed	A - Excellent	Potassium Ferricyanide	B - Good			Whiskey & Wines	A - Excellent																																																																																																																																																																																																																																																																																																																																																																																										
Oils: Linseed	A - Excellent	Potassium Ferricyanide	B - Good			Xylene	A - Excellent																																																																																																																																																																																																																																																																																																																																																																																										
Oils: Mineral	A - Excellent	Potassium Iodide	B - Good																																																																																																																																																																																																																																																																																																																																																																																														
Oils: Olive	A - Excellent	Potassium Nitrate	A - Excellent																																																																																																																																																																																																																																																																																																																																																																																														
Oxalic Acid	A - Excellent	Potassium Oxalate	A - Excellent																																																																																																																																																																																																																																																																																																																																																																																														
Oxalic Acid (cold)	A - Excellent	Potassium Permanganate	A - Excellent																																																																																																																																																																																																																																																																																																																																																																																														
Paraffin	A - Excellent	Potassium Sulfate	A - Excellent																																																																																																																																																																																																																																																																																																																																																																																														
Perchloroethylene	A - Excellent																																																																																																																																																																																																																																																																																																																																																																																																
Phenol (10%)	A - Excellent																																																																																																																																																																																																																																																																																																																																																																																																
Phenol (Carbolic Acid)	A - Excellent																																																																																																																																																																																																																																																																																																																																																																																																
Phosphoric Acid (5-40%)	A - Excellent																																																																																																																																																																																																																																																																																																																																																																																																
Phosphoric Acid (5-40%)	A - Excellent																																																																																																																																																																																																																																																																																																																																																																																																
Photographic Developer	A - Excellent																																																																																																																																																																																																																																																																																																																																																																																																
Plating Solutions, Lead Fluoborate Plating	A - Excellent																																																																																																																																																																																																																																																																																																																																																																																																
Plating Solutions, Rhodium Plating 120°F	A - Excellent																																																																																																																																																																																																																																																																																																																																																																																																
Potassium Bicarbonate	A - Excellent																																																																																																																																																																																																																																																																																																																																																																																																
Potassium Chlorate	B - Good																																																																																																																																																																																																																																																																																																																																																																																																
Potassium Chromate	B - Good																																																																																																																																																																																																																																																																																																																																																																																																
Potassium Dichromate	B - Good																																																																																																																																																																																																																																																																																																																																																																																																
Potassium Ferricyanide	B - Good																																																																																																																																																																																																																																																																																																																																																																																																
Potassium Ferricyanide	B - Good																																																																																																																																																																																																																																																																																																																																																																																																
Potassium Iodide	B - Good																																																																																																																																																																																																																																																																																																																																																																																																
Potassium Nitrate	A - Excellent																																																																																																																																																																																																																																																																																																																																																																																																
Potassium Oxalate	A - Excellent																																																																																																																																																																																																																																																																																																																																																																																																
Potassium Permanganate	A - Excellent																																																																																																																																																																																																																																																																																																																																																																																																
Potassium Sulfate	A - Excellent																																																																																																																																																																																																																																																																																																																																																																																																
<p>Prep. C. FORLANI</p> <p>App. P. GUZZETTI</p> <p>First Issue: _____</p> <p>NOTE: _____</p> <p>Dec. No. 43911769</p> <p>Scale 1:1</p> <p>Scale 1:1</p> <p>Scale 1:1</p> <p>Scale 1:1</p>																																																																																																																																																																																																																																																																																																																																																																																																	
<p>ELECTRONSISTEM MD S.r.l.</p> <p>SGM/A analog relative pressure sensor</p>																																																																																																																																																																																																																																																																																																																																																																																																	

All specs are subject to change without notice

STORAGE

If the complex must be storage before use, please keep dry and repaired.

Do not leave outdoor.

Device is strongly sensitive to humidity hence avoid to store where relative humidity is more than 90%

STORAGE TEMPERATURE: $-30^{\circ}\text{C} \div +70^{\circ}\text{C}$

RELATIVE HUMIDITY: max 90% @ $+40^{\circ}\text{C}$

MAINTENANCE

Maintenance of transmitter must be done compulsory in factory. We recommend every 5 years to send back transmitter for calibration check and inspection.

WARRANTY

Device is covered by 24 months after installation or max 36 months after delivery.

In case of service the transmitter must be sent back to factory for inspection.

WARNINGS

CAUTION

Do not drop or hit the transmitter. The sensor is fragile and may break from sudden shock. When transporting the transmitter, use the original shipping box from Electronsistem MD.

NOTE

Keep the transmitter dry and clean.

Do not remove the transparent transport protection caps before you are ready to install the transmitter.

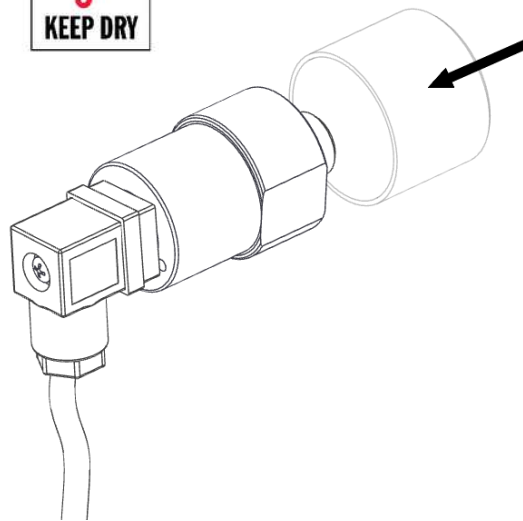

NOTE

Connect the transmitter directly to the main gas volume, not behind a sampling line because this is the area where high humidity tends to accumulate and where the temperature of gas is not the imagine of gas near breaker.

The use of original cable wiring is advised to have the better protection performances.

INSTALLATION

1. Remove the transparent transport cap when you are ready to install the transmitter. Check o-ring is clean without dust and properly assembled.

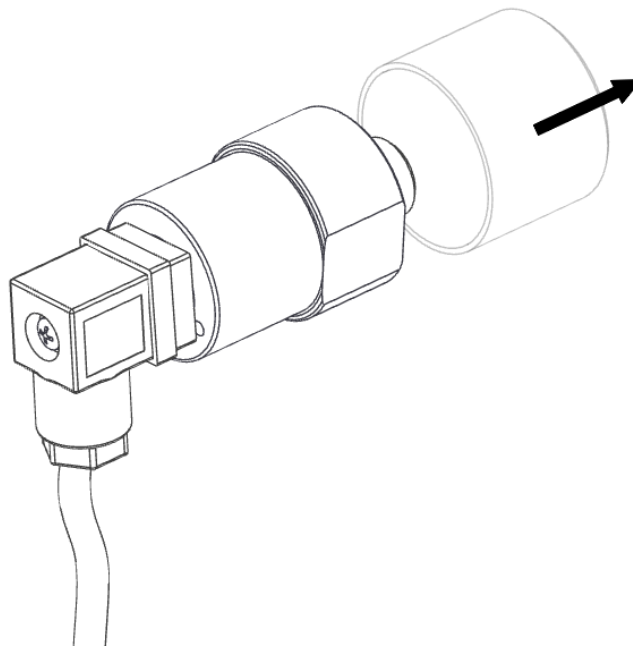

All specs are subject to change without notice

Gas pressure transmitter

2. Install the transmitter to the mechanical coupling and tighten gently by hand. Then use a 27mm wrench to tighten the connection. Use a sufficient force to achieve a tight installation (recommended 10-15Nm) . The system must be leak-free for accurate measurement.

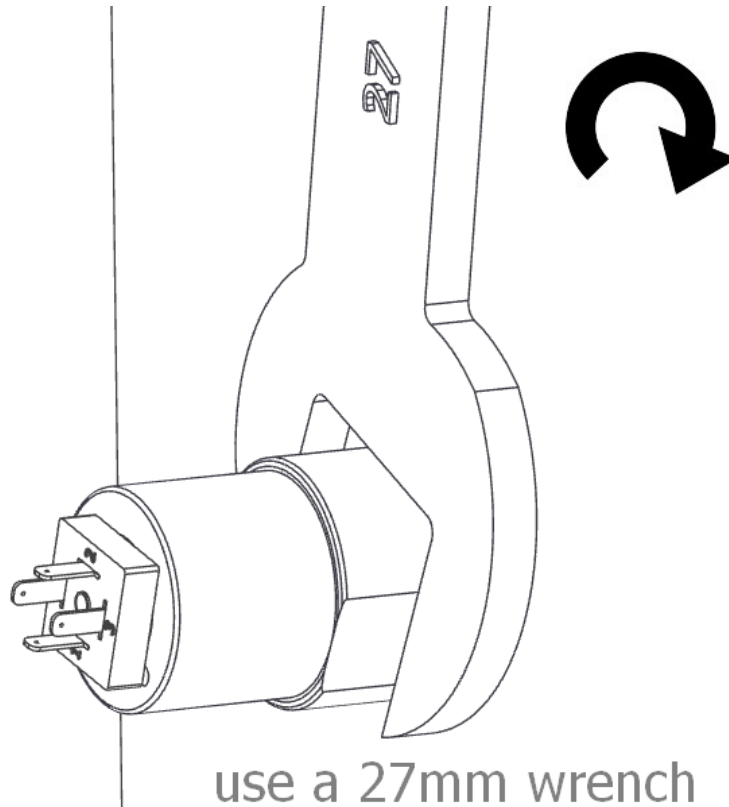

Gas pressure transmitter

3. Connect proper wiring into the output port checking the correct polarization of the connector and checking the presence of the squared seal.

Then insert the screw supplied and tight the screw with a screwdriver

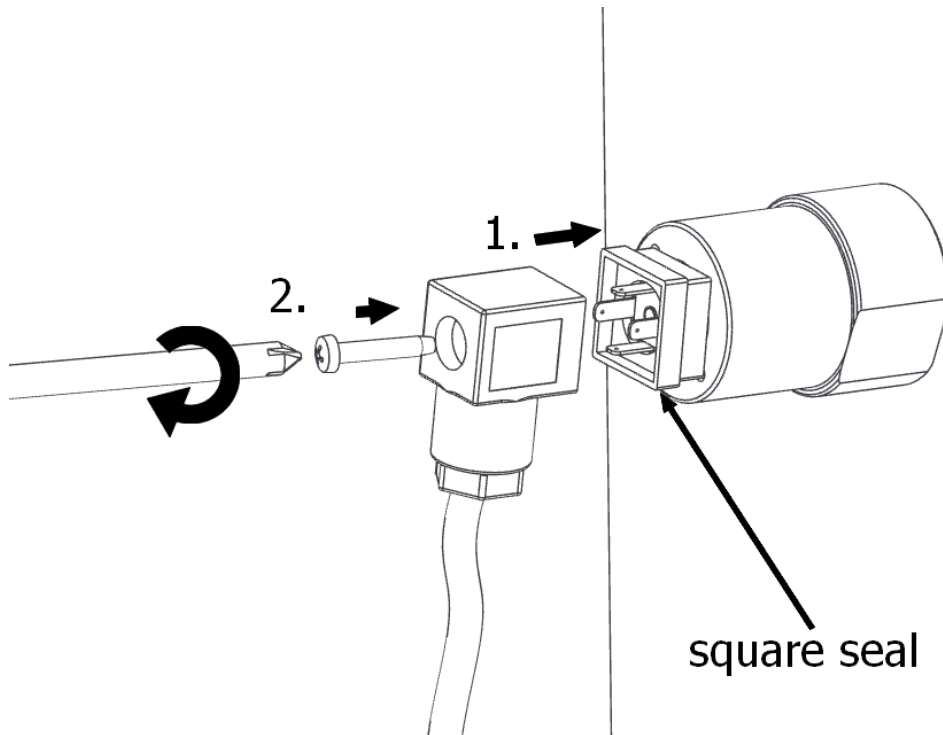
**DISCLAIMER NOTE:**

While we provide application assistance it is up to the customer to determine the suitability for its use.

Specification may change without notice. The information we supply is believed to be accurate and reliable as of this printing. However we assume no responsibility for its use.

The quality of ElectronsystemMD products is guaranteed by a Quality, Safety and Environmental management system certified by DNV according to ISO 9001, ISO 18001 and ISO 14001. Electronsystem MD works in partnership with its customers in designing customized executions in order to meet specific requirements, please contact us.

All specs are subject to change without notice